



# APPENDIX

## Riverfront Park Visions from Open House Participants

Open House #1  
March 8, 2014

APPENDIX: COMPLETED VISION EXHIBITS

1



Gate way "to" & "from" Caroline Street - Must be clearly drawing people both ways -

Arch / Seating

Unique pavement an

Scale: 0' 20' 40' 80'

Fredericksburg Riverfront Park "My Vision For This Park Is"...

WHOBESIDE | HARWELL 03.28.2014

2

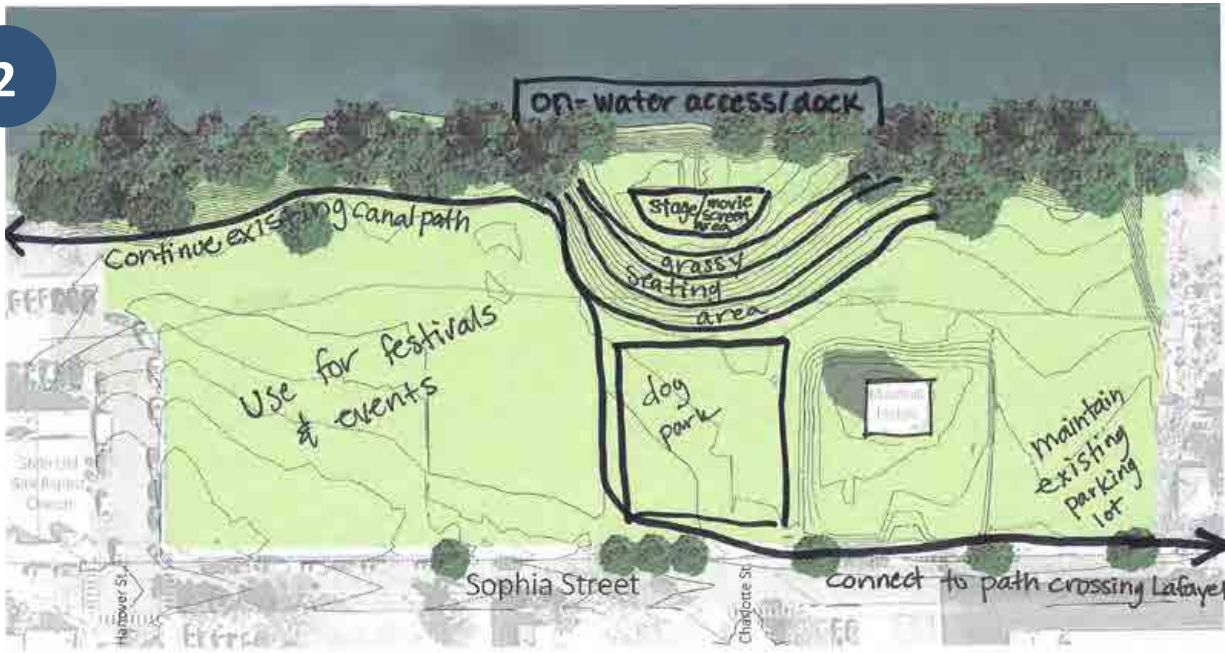

On-water access/dock

Stage/movie screen area

grassy seating area

dog park

Masonic Lodge

Use for festivals & events

Continue existing canal path

Maintain existing parking lot

Connect to path crossing Lafayette

Scale: 0' 20' 40' 80'

Convert existing gravel parking lot into dog park

Keep Masonic Lodge for: - restrooms - small meeting space/ren - first aid location - ~~interpretative center?~~ - Interpretative center?

Main-tain existing shade trees

- Add vegetation along riverbank that would prevent erosion
- Add more plants to existing grassy areas.

Fredericksburg Riverfront Park "My Vision For This Park Is"...

WHOBESIDE | HARWELL 03.28.2014



APPENDIX: COMPLETED VISION EXHIBITS

3



Event stage w/ amphitheater seating  
 Masonic lodge used as centerpiece for shade structure (awnings all around)  
 Small parking area w/ wall separating parking from park

Fredericksburg Riverfront Park "My Vision For This Park Is" ... RHODES/IRVING/HARWELL 02/06/2014

4

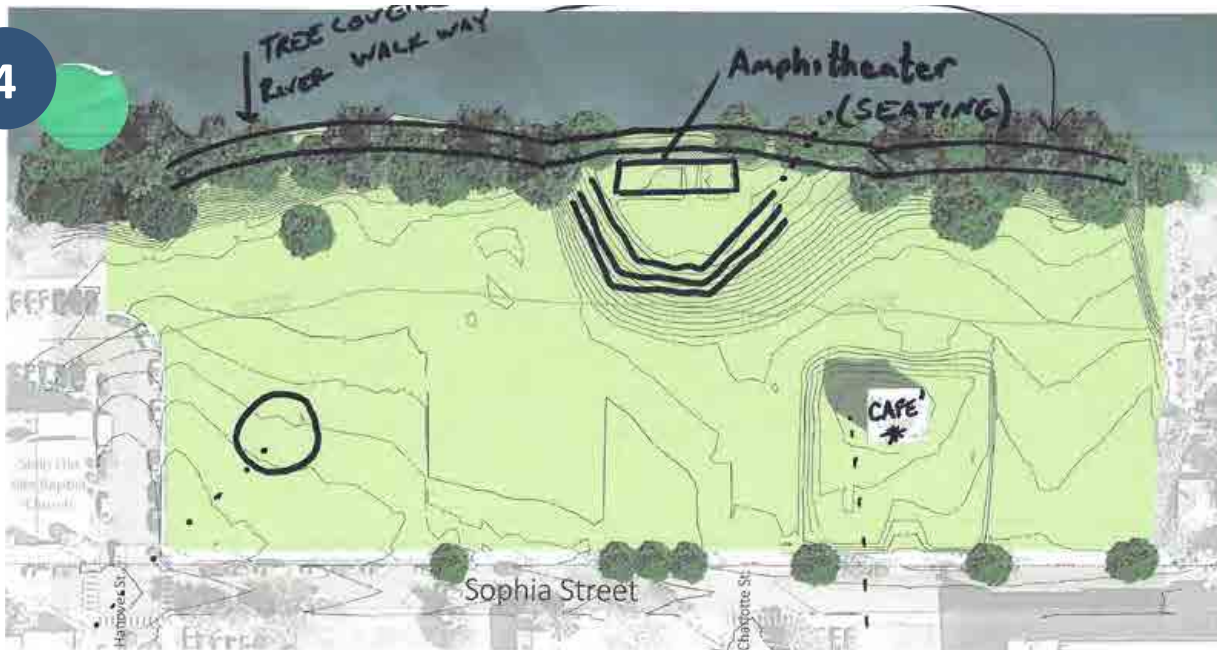

WATER FEATURE  
 &  
 TRIBUTE TO CITY'S HISTORIC PAST (ESP. CIVIL WAR PAST)  
 Bathrooms!  
 - AREA FOR BICYCLE PARKING  
 No DOG PARK  
 \* OBSERVATION "DECK" ?

Fredericksburg Riverfront Park "My Vision For This Park Is" ... RHODES/IRVING/HARWELL 02/06/2014

APPENDIX: COMPLETED VISION EXHIBITS

5

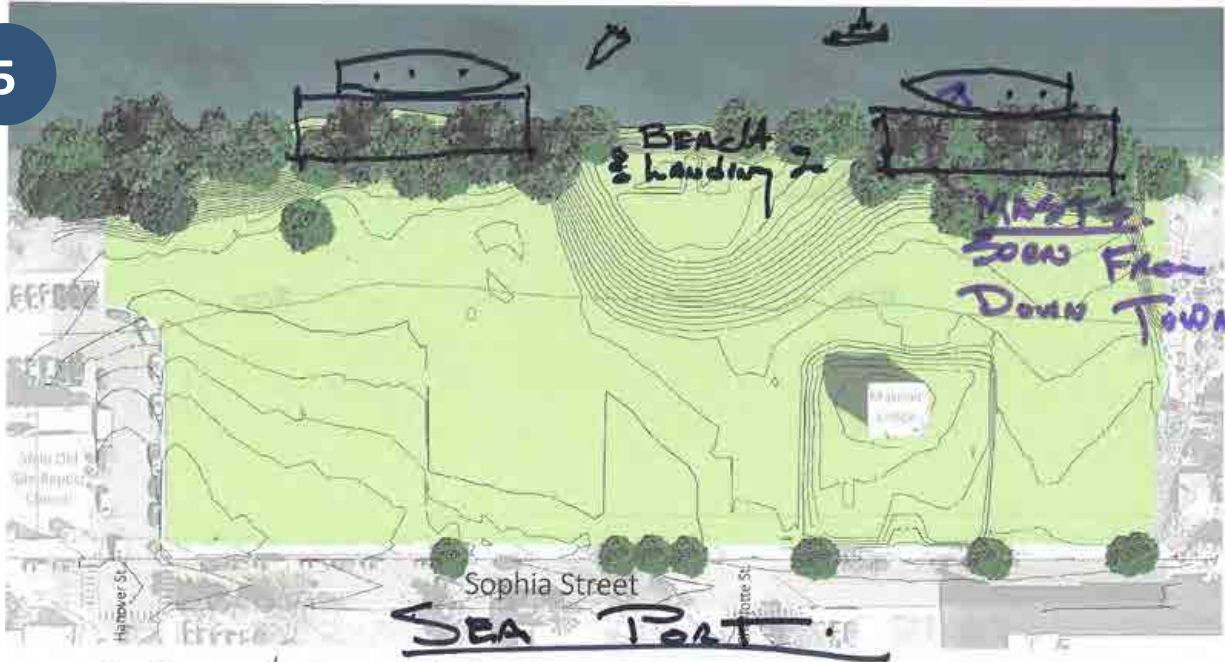

- History of Fredericksburg AS Sea port
- What would George Washington See MASSIVE



Fredericksburg Riverfront Park "My Vision For This Park Is..."

BRUNNEN HABWELL 05.08.2014

6



- \* would like simply landscaping w/ colors for all seasons
- \* Take brick off of ledge - re-purpose as public bathrooms, w/ deck to view river ice cream/cottages shop
- \* include passive/encl friendly historic markers or some type of memorial for african am who lived here in this
- \* eco-friendly lighting
- \* if possible remove parking
- \* amp. theater for out door plays/concerts but w/ steps and walk that could be used for viewing RIVER & possibly climbing

Fredericksburg Riverfront Park "My Vision For This Park Is..."

BRUNNEN HABWELL 05.08.2014



7



- (A) RIVER WALK - CLOSE TO WATER
- (B) HIGH OVERLOOK
- (C) BRIDGE TO SCOTT'S ISL.
- (D) RAMP TO LOW FLOATING DOCK  
CANOE + SHLL COMPATIBLE
- (E) MASONIC LOG UNWRAPPED OR DEMO'S UNLESS FUNCTION FOUR
- (F) WATER FALL
- (W) WATER PARK AKA FAIRFAX COUNTRY SOUTH



1. Treat the river edge in the 100-year flood plain SOFT with native plantings.
2. Have a walkway parallel to the river at the edge of the 100-yr line with railing.
3. Have a 'peace' grove with soft pathways, sycamores and cherry trees, and a variety of seating clusters. There currently is no where windown town where people can take a break and relax.

9



Local Art in The Park  
 No parking within The park.  
 Masonic lodge not "historically" significant enough to preserve  
 Physical Access to The water  
 Foresting plantings + Cherry trees -  
 Fredericksburg Riverfront Park "My Vision For This Park Is" ...  
 Facilities for multiple use/activities -

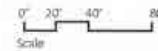

RHODESIDE · HAWELL  
 03.08.2014

10



Am interested in a "natural" setting; everypine along river.  
 no parking (make streets available of parking garage use)  
 Curvilinear lines for walkways - no straight lines, use ecopavers when possible  
 underground bathrooms, covered with grass or usable natural surface  
 Ecopavers to secure shorelines, using native trees, plants. Water access everywhere  
 Connect "walking, biketrails" as much as possible along river.  
 Fredericksburg Riverfront Park "My Vision For This Park Is" ...

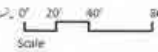

RHODESIDE · HAWELL  
 03.08.2014



11



Fredericksburg Riverfront Park "My Vision For This Park Is"...

ARCHITECTURE: HANWELL  
DATE: 2014

12

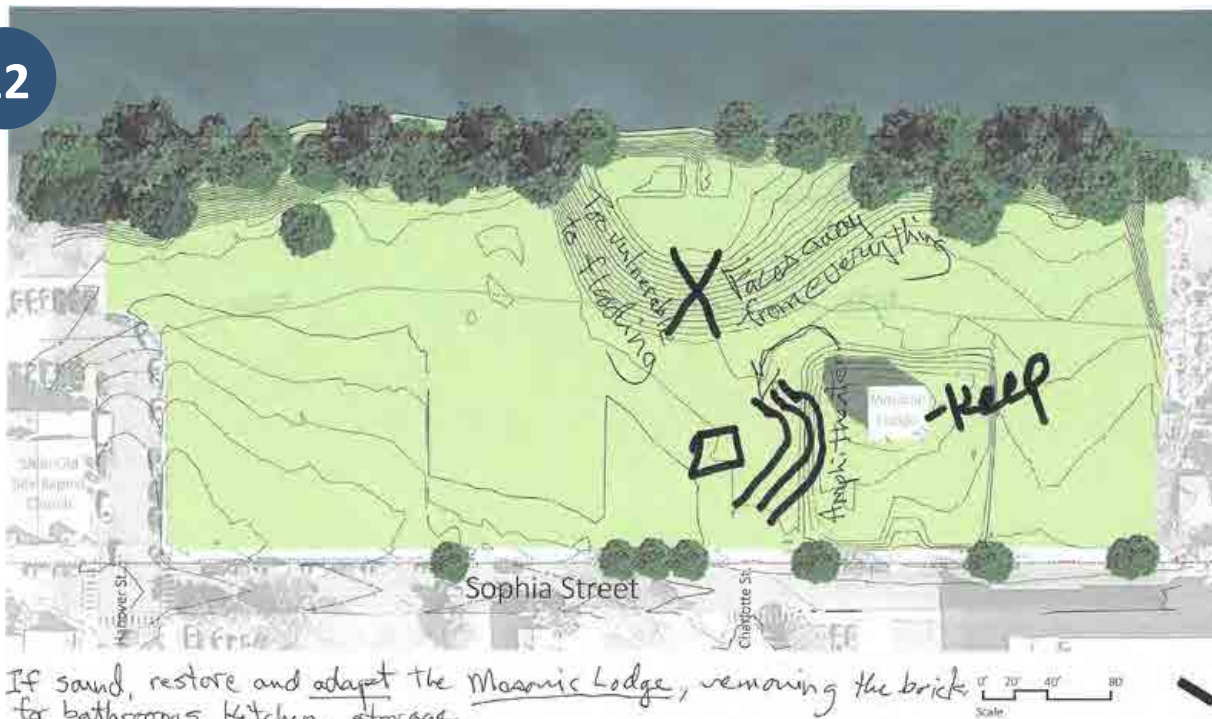

If sand, restore and adapt the Masonic Lodge, removing the bricks for bathrooms, kitchen, storage.

Preserve foundational remains.

move the amphitheater away from the water. Put it closer to Sophia St. and perpendicular to Sophia St. so it is better integrated with the space where large public events and festivals will be held. This will also minimize its vulnerability to flooding. If you keep it facing the water, you'll need a shell that will block the view of the river.

Fredericksburg Riverfront Park "My Vision For This Park Is"...

ARCHITECTURE: HANWELL  
DATE: 2014

13



Please include location specialness.  
 LAST SECTION of the State  
 Scenic River designation of  
 the Rappahannock. Goes to Mayfield-  
 Ferry Farm Bridge.

14

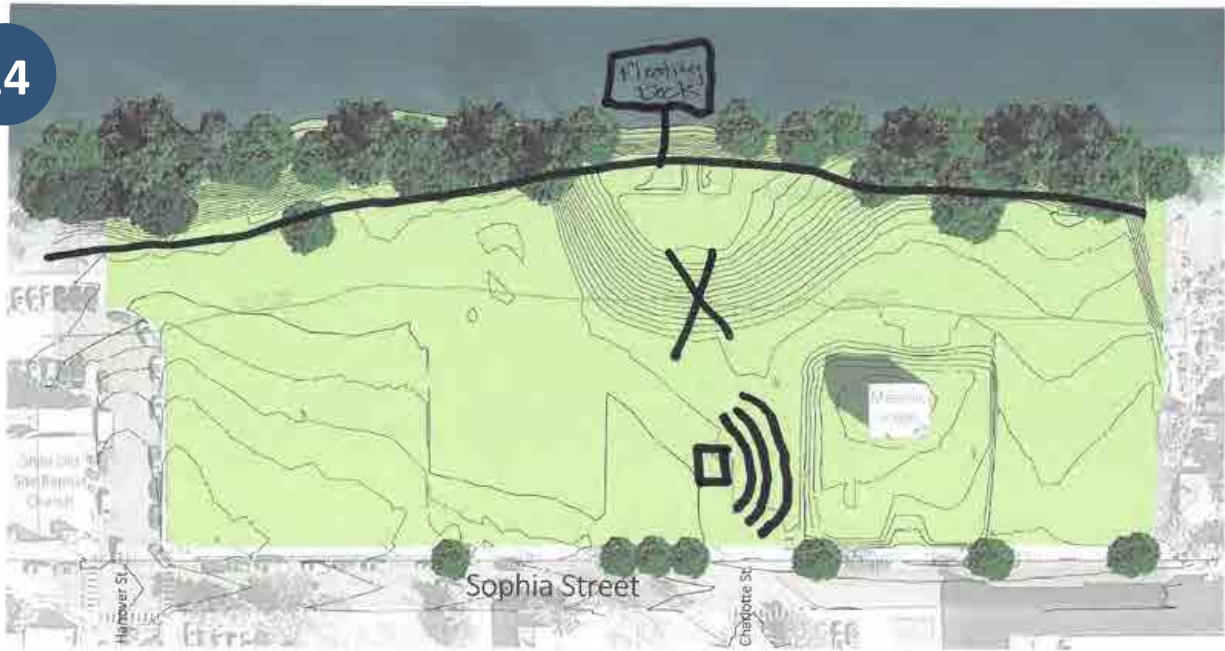

1. From a walkway at the edge of the 100-yr flood plain, have a ramp that goes down to a floating deck that allows people to get close to the water and enjoy the views up and down the river.
2. The deck will allow people in canoes, kayaks, small boats to access the park from the water and allow fishing



15



think parking should move off site to make more park  
 easy access to view the water - maybe a board walk along  
 the edge to preserve river banks.  
 eco-pavers can provide friendly environmental  
 surface for high traffic areas

Fredericksburg Riverfront Park "My Vision For This Park Is"...

RHOODESIDE-HARWELL  
 03.26.2014

16

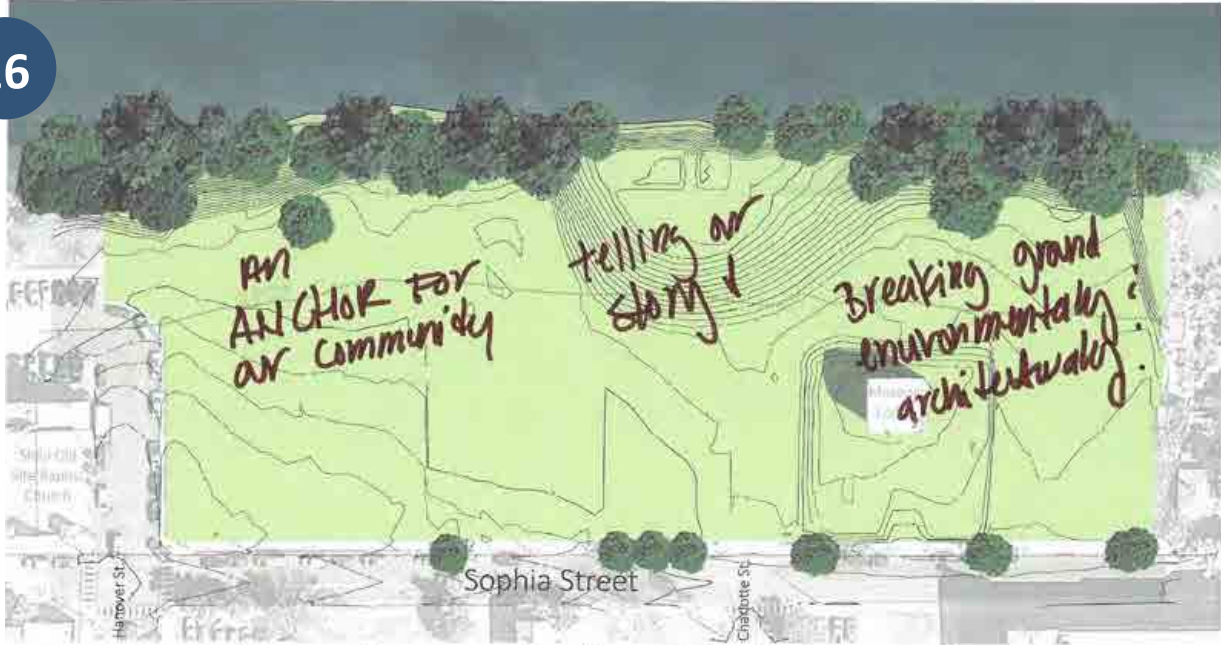

- AN ANCHOR for downtown - Having the ability to bring people downtown all year long and lots of people
- Telling our History - This project has the ability to tell the entire history; importance of the river
- Breaking Ground - Breaking ground architecturally! environmentally setting a high standard.

Fredericksburg Riverfront Park "My Vision For This Park Is"...

RHOODESIDE-HARWELL  
 03.26.2014

17



Fredericksburg Riverfront Park "My Vision For This Park Is"...

RHODESIDE HARWELL 03/08/2016

18

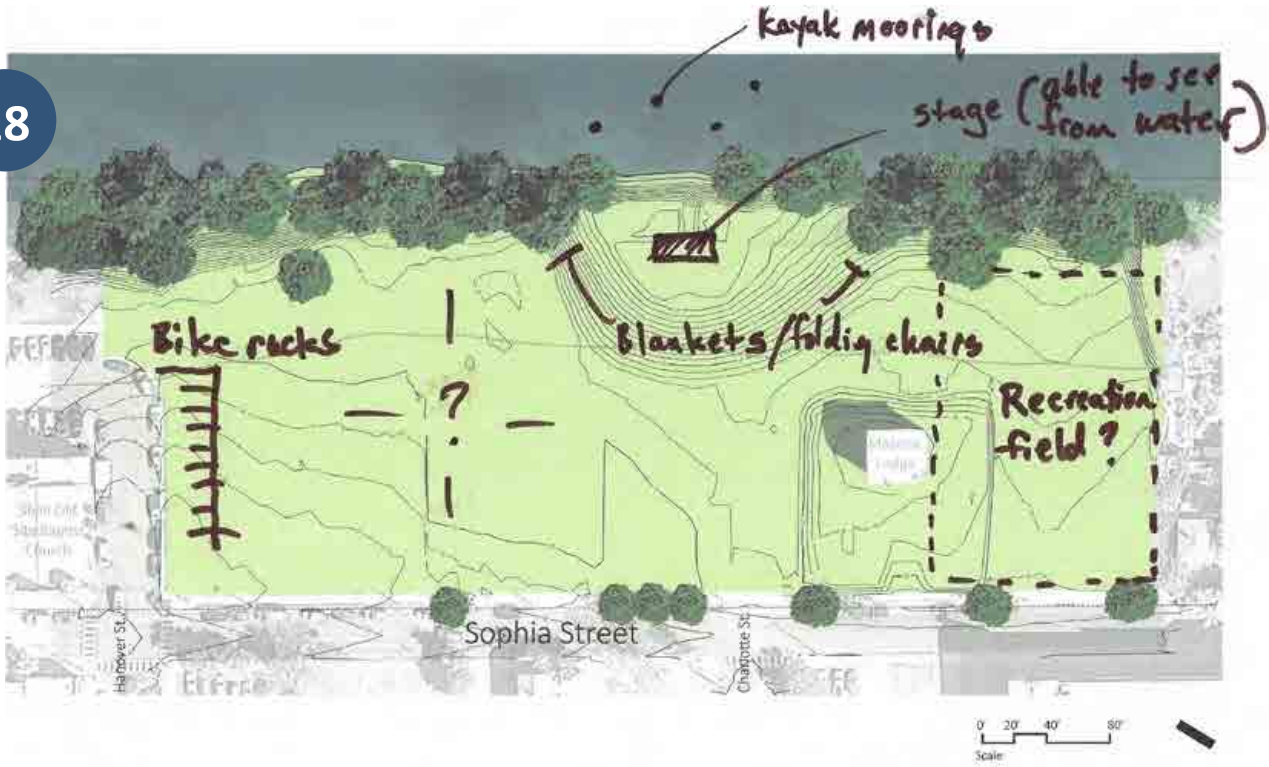

Fredericksburg Riverfront Park "My Vision For This Park Is"...

RHODESIDE HARWELL 03/08/2016



19



Fredericksburg Riverfront Park "My Vision For This Park Is..."

SHOPE/SIDE (HARWELL)  
03/08/2018

20



An outdoor exhibit that captures the history of Civil Rights - Jewish, Black, LGBTQ  
Statistic Displays ~~with~~ for traveling Exhibits or Art Collection

Fredericksburg Riverfront Park "My Vision For This Park Is..."

SHOPE/SIDE (HARWELL)  
03/08/2018

21



Fredericksburg Riverfront Park "My Vision For This Park Is"...

RHODESIDE/HARWELL  
03/08/2014

22



Fredericksburg Riverfront Park "My Vision For This Park Is"...

RHODESIDE/HARWELL  
03/08/2014



23

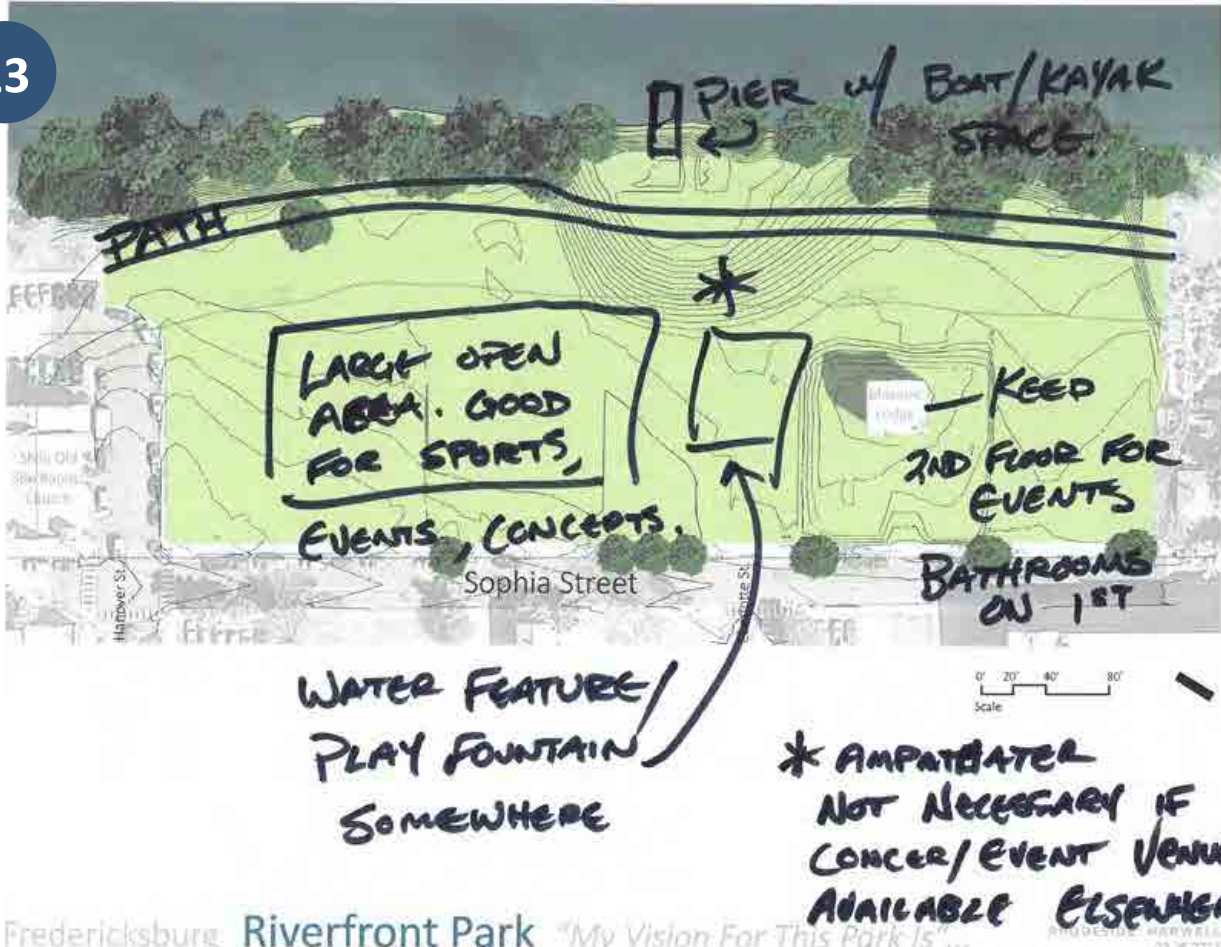

Fredericksburg Riverfront Park "My Vision For This Park Is"...

BRADSHAW-HARVEY 03.06.2014

24

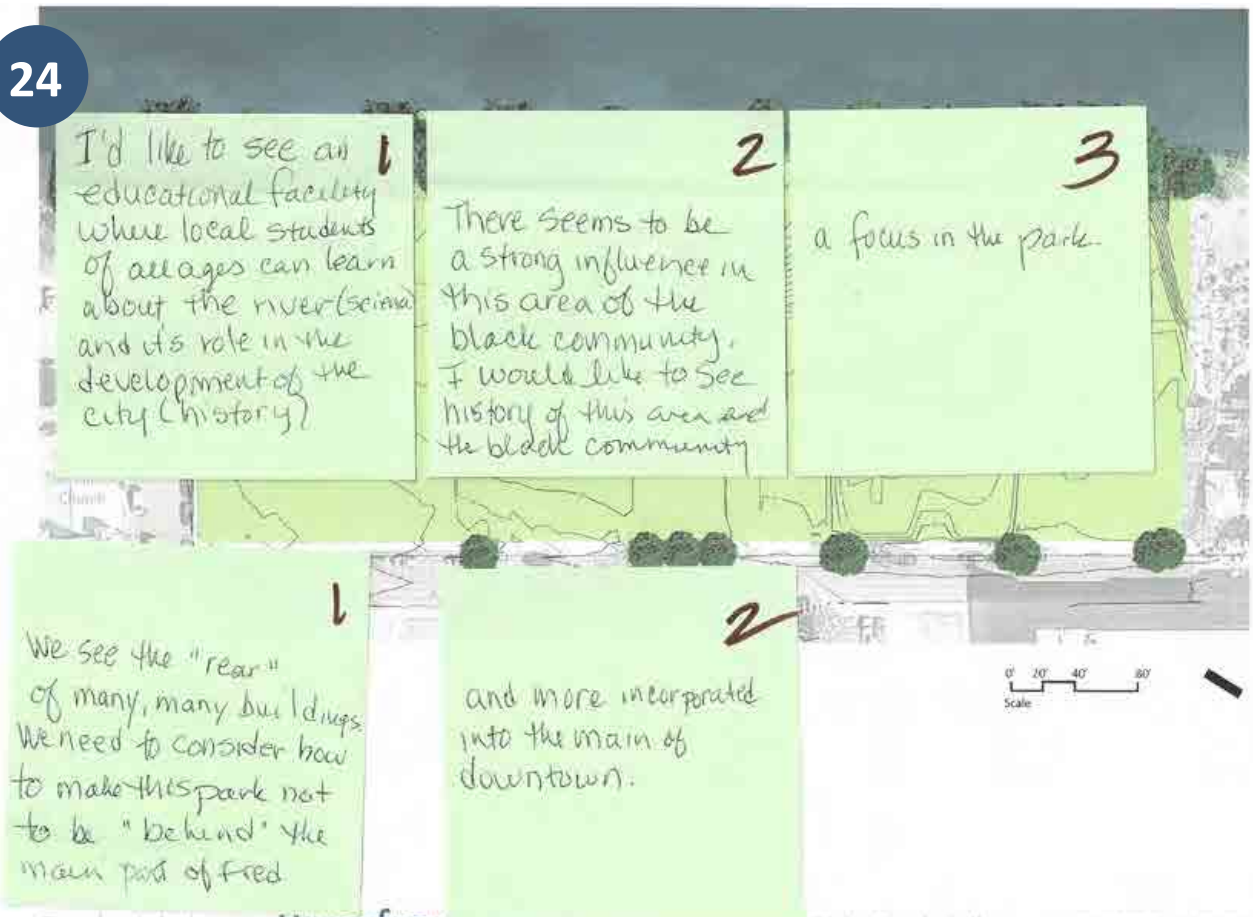

Fredericksburg Riverfront Park "My Vision For This Park Is"...

BRADSHAW-HARVEY 03.06.2014



- PARKING
- CONNECTIVITY -
  - TRAILS, PATHS
  - OLD STONE WAREHOUSE
  - CITY DOCK, ROLLY LANE, DIXON PARK
  - STAFFORD SIDE / VIEW SIDE
- NATURAL

Fredericksburg Riverfront Park "My Vision" (SEE ATTACHED)